

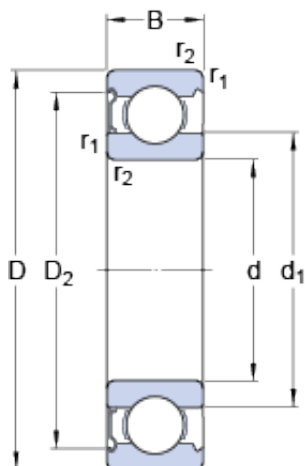

FTR BEARING WHOLESALE LTD



80 mm x 170 mm x 39 mm skf 6316-Z Deep groove ball bearings

Bearing No. 6316-Z

6316-Z Bearing 2D drawings and 3D CAD models

Size	170x80x39 mm
Bore Diameter	170 mm
Outer Diameter	80 mm
Width	39 mm
d	80 mm
D	170 mm
B	39 mm
d ₁	108 mm
D ₂	146.9 mm
r _{1,2} - min.	2.1 mm
d _a - min.	92 mm
d _a - max.	107.9 mm
D _a - max.	158 mm
r _a - max.	2 mm
Basic dynamic load rating - C	130 kN
Basic static load rating - C ₀	86.5 kN
Fatigue load limit - P _u	3.2 kN
Reference speed	8500 r/min
Limiting speed	5300 r/min
Calculation factor - k _r	0.03
Calculation factor - f ₀	13
Category	Single Row Ball Bearings
Inventory	0.0
Manufacturer Name	SKF



FTR BEARING WHOLESALE LTD

Minimum Buy Quantity	N/A
Weight / Kilogram	0
EAN	7316577297914
Product Group	B00308
Enclosure	1 Metal Shield
Precision Class	ABEC 1 ISO P0
Maximum Capacity / Filling Slot	No
Rolling Element	Ball Bearing
Snap Ring	No
Internal Special Features	No
Cage Material	Steel
Internal Clearance	C0-Medium
Inch - Metric	Metric
Long Description	80MM Bore; 170MM Outside Diameter; 39MM Outer Race Width; 1 Metal Shield; Ball Bearing; ABEC 1 ISO P0; No Filling Slot; No Snap Ring; No Internal Special Features; C0-Medium Internal Clearance; Stee
Other Features	Deep Groove
Category	Single Row Ball Bearing
UNSPSC	31171504
Harmonized Tariff Code	8482.10.50.68
Noun	Bearing
Keyword String	Ball
Manufacturer URL	http://www.skf.com
Weight / LBS	8.0883
Outer Race Width	1.535 Inch 39 Millimeter
Inner Race Width	0 Inch 0 Millimeter
Bore	3.15 Inch 80 Millimeter
Outside Diameter	6.693 Inch 170 Millimeter



FTR BEARING WHOLESALE LTD

d_1	108 mm
D_2	146.9 mm
$r_{1,2}$ min.	2.1 mm
d_a min.	92 mm
d_a max.	107.9 mm
D_a max.	158 mm
r_a max.	2 mm
Basic dynamic load rating C	130 kN
Basic static load rating C_0	86.5 kN
Fatigue load limit P_u	3.25 kN
Calculation factor k_r	0.03
Calculation factor f_0	13.3
Mass bearing	3.67 kg