

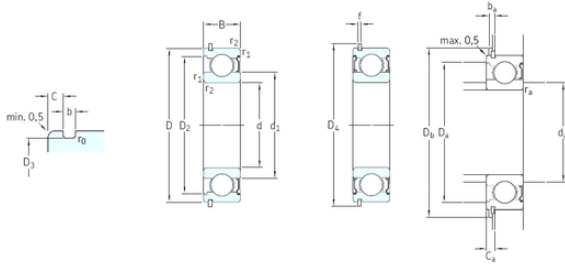

FTR BEARING WHOLESALE LTD



30 mm x 62 mm x 16 mm skf 6206-2ZNR Deep groove ball bearings

Bearing No. 6206-2ZNR

6206-2ZNR Bearing 2D drawings and 3D CAD models

Size	30x62x16 mm
Bore Diameter	30 mm
Outer Diameter	62 mm
Width	16 mm
d	30 mm
D	62 mm
B	16 mm
C	16 mm
b	1,9 mm
d1	40,3 mm
f	1,7 mm
r0 max.	0,6 mm
r1 min.	1 mm
r2 min.	1 mm
C	3,28 mm
D2	54,1 mm
D3	59,61 mm
D4	67,7 mm
ba min.	4,98 mm
Ca max.	4,98 mm
da min.	2,2 mm
da max	40,3 mm
Da max.	56,4 mm
Db min.	69 mm
ra max.	1 mm



FTR BEARING WHOLESALE LTD

Weight	0,21 Kg
Basic dynamic load rating (C)	20,3 kN
Basic static load rating (C0)	11,2 kN
Fatigue load limit (Pu)	0,475
Reference speed	24000 r/min
Limiting speed	15000 r/min
Calculation factor (f0)	14
Category	Single Row Ball Bearings
Inventory	0.0
Manufacturer Name	SKF
Minimum Buy Quantity	N/A
Weight / Kilogram	0.206
EAN	7316571404233
Product Group	B00308
Enclosure	2 Metal Shields
Precision Class	ABEC 1 ISO P0
Maximum Capacity / Filling Slot	No
Rolling Element	Ball Bearing
Snap Ring	Yes
Internal Special Features	No
Cage Material	Steel
Internal Clearance	C0-Medium
Inch - Metric	Metric
Long Description	30MM Bore; 62MM Outside Diameter; 16MM Outer Race Width; 2 Metal Shields; Ball Bearing; ABEC 1 ISO P0; No Filling Slot; Yes Snap Ring; No Internal Special Features; C0-Medium Internal Clearance; Ste
Other Features	Deep Groove With Snap Ring



FTR BEARING WHOLESALE LTD

Category	Single Row Ball Bearing
UNSPSC	31171504
Harmonized Tariff Code	8482.10.50.68
Noun	Bearing
Keyword String	Ball
Manufacturer URL	http://www.skf.com
Manufacturer Item Number	6206-2ZNR
Weight / LBS	0.481
Outer Race Width	0.63 Inch 16 Millimeter
Bore	1.181 Inch 30 Millimeter
Inner Race Width	0 Inch 0 Millimeter
Outside Diameter	2.441 Inch 62 Millimeter
d_1	40.36 mm
D_2	54.06 mm
D_3	59.61 mm
r_0 max.	0.6 mm
$r_{1,2}$ min.	1 mm
d_a min.	35.6 mm
d_a max.	40.3 mm
D_a max.	56.4 mm
D_b min.	69 mm
b_a min.	2.2 mm
C_a max.	4.98 mm
r_a max.	1 mm
Basic dynamic load rating C	20.3 kN
Basic static load rating C_0	11.2 kN
Fatigue load limit P_u	0.475 kN
Calculation factor k_r	0.025
Calculation factor f_0	14
Mass bearing	0.21 kg
Snap ring	SP 62